

HOMER TOWNSHIP FRACTION 17 R13 TWP 7 MORGAN COUNTY, OH

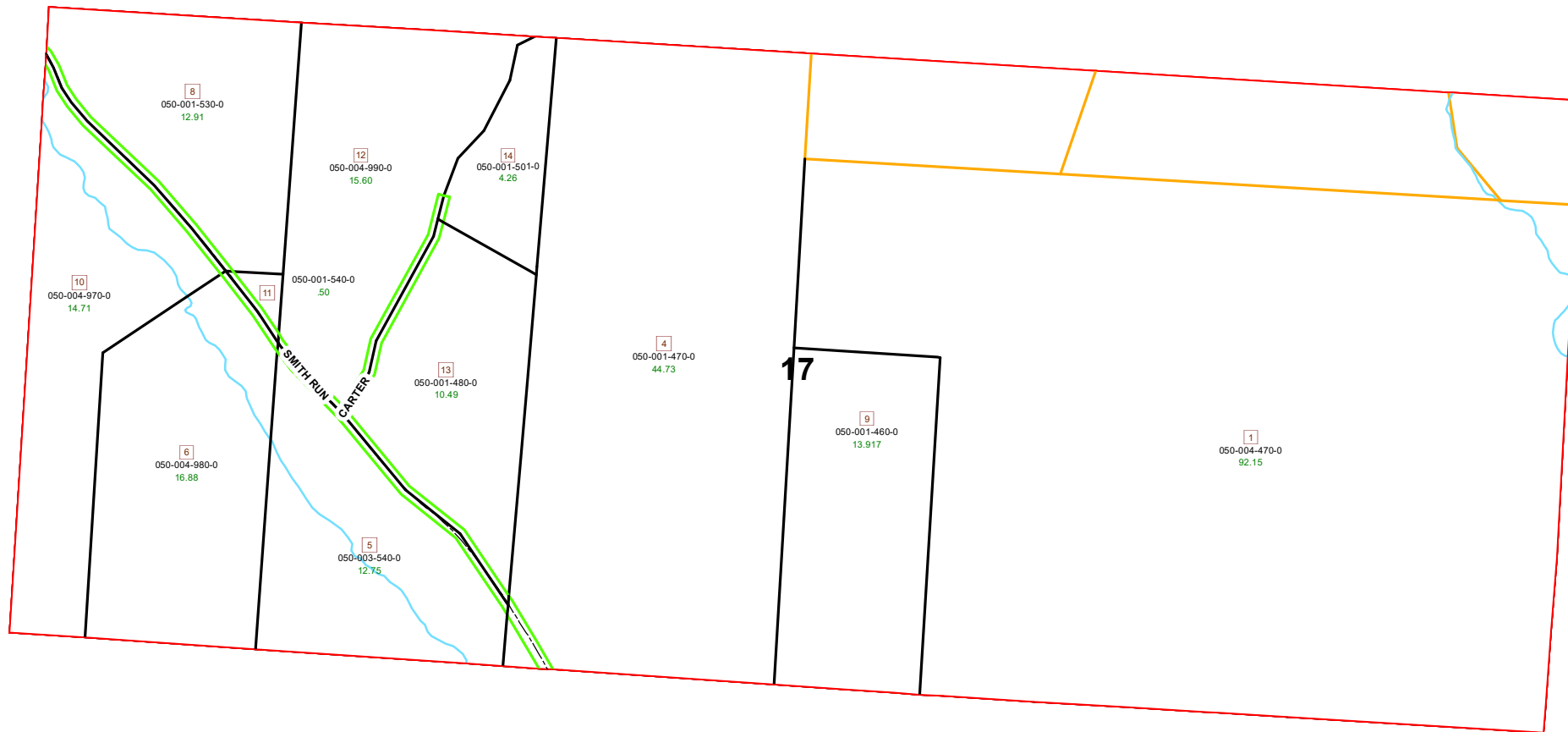

PIN	VOL	PAGE	Owner	LegalDescr	Acres
050-001-480-0	OR204	891	ADKINS MARSHA K & THOMAS L	R13 T07 S00 FR 17	10.493
050-001-501-0	OR225	1234	ADKINS MARSHA K & THOMAS L	R13 T07 S17 SD 14	4.265
050-001-460-0	OR223	1863	BRUNSWICK RONALD H & CLARA M	R13 T07 S00 FR 17	13.917
050-001-470-0	OR223	1863	BRUNSWICK RONALD H & CLARA M	R13 T07 S00 FR 17	44.732
050-003-540-0	OR229	1172	DEARTH CHARLES DAVID SR & JODY JEA	R13 T07 S00 FR 17	12.788
050-004-990-0	OR65	734	EDGINGTON DOUGLAS E	R13 T07 S00 FR 17	15.6
050-004-980-0	OR66	549	ELLIOTT DARROLD D & LOU ANN BAUER	R13 T07 S00 FR 17	16.88
050-004-970-0	OR66	549	ELLIOTT DARROLD D & LOU ANN BAUER	R13 T07 S00 FR 17	14.71
050-001-540-0	OR108	697	LOUDERMILK JAMES JESSE ET2AL	R13 T07 S00 FR 17	0.5
050-001-530-0	OR108	697	LOUDERMILK JAMES JESSE ET2AL	R13 T07 S00 FR 17	12.91
050-004-470-0	OR165	360	MARCUM WILLIAM R & KATRINA M	R13 T07 S00 FR 17	92.15

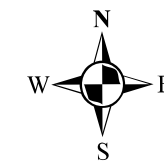

Boundaries	
----- Hidden	--- ROW
--- Hydro	--- Section
--- Roads	--- Lot
--- County	--- Parcel
----- Township	--- Parcels

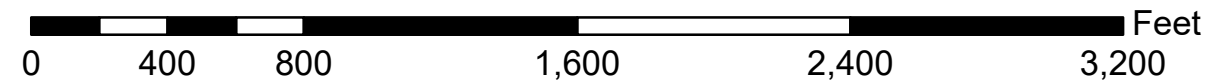

Disclaimer: The information that these maps contains is for reference purposes only. Please bring any errors to the attention of the Engineer's Office staff.
Thank you